



ARROWHEAD
R O C K D R I L L
HYDRAULIC HAMMERS, TOOLS & PARTS™

S180

PARTS MANUAL

S180 PARTS LIST AND DRAWINGS

Item No.	Part No.	Description	Qty.
1	S180-001	Main Body	1
2	S180-002A	Chuck Housing	1
3	S180-003C	Main Valve Complete	1
3A	S180-003	Valve Housing (Bare)	1
3B	S180-019	Valve Spool	1
3C	S180-020	Main Valve Top Plate	1
3D	S180-021	Main Valve Bottom Plate	1
3E	S180-029	Plunger	1
3F	ARC-097	22mm Pressure Plug	1
3G	ARC-100	8mm Pressure Plug	1
3H	ARC-055	Socket Head Capscrew (Top & Bottom Valve Plate)	8
4	S180-004	Cylinder Head	1
5	S180-006	Piston	1
6	S180-007	Upper Cylinder Liner	1
7	S180-008	Lower Cylinder Liner	1
8	S180-009	Disc Washers	2
9	S180-010	Spacer	1
10	S180-013	Tie Rod	4
11	S180-014	Top Nut	4
12	S180-015	Bottom Nut	4
13	S180-063A	Tie Rod Washer	4
14	S180-017	Tool Retainer Pin	1
15	ARC-001	Dowel Pin	2
16A	S180-026P	Tool (Point)	1
16B	S180-026C	Tool (Chisel)	1
16C	S180-026B	Tool (Blunt)	1
17A	ARC-005	Grease Nipple	1
17B	ARC-125	1" BSP Male - 1/4" Female - Reducing Plug	1
18	ARC-056	Socket Head Capscrew (Valve to Main Body)	10
19	ARC-008	Gas Valve Assembly	1
19A	ARC-008A	Gas Valve Dust Cap	1
19B	ARC-008B	Gas Valve Body	1
19C	ARC-008C	"O" Ring	2
19D	ARC-008D	1" Dowty Washer	1
19E	ARC-008E	"O" Ring	1
19F	ARC-008F	Gas Valve Shuttle	1
19G	ARC-008G	Gas Valve Spring	1
20	S180-059	Seal Kit Complete	1
20A	S180-059-1	"U" Seal	5
20C	S180-059-3	Wiper Ring	1
20D	S180-059-4	"O" Ring Cylinder Liner	9
20E	S180-059-5	"O" Ring Main Valve Top & Bottom Plates	3

20G	S180-059-7	"O" Ring Valve to Main Body	1
20H	S180-059-8	"O" Ring Valve to Main Body	2
20J	S180-059-9	"O" Ring Cylinder Head to Main Body Face Seal	1
20K	S180-059-10	P.T.F.E. Back Up Ring Valve to Main Body	2
20L	S180-059-11	P.T.F.E. Back Up Ring Valve to Main Body	1
20M	S180-059-12	Bronze Filled Back Up Ring Cylinder Liner	10
20N	S180-059-13	P.T.F.E. Back Up Ring Main Valve Top & Bottom Plates	3
21	ARC-029	Inlet Adaptor 1" BSP x 1" 1/16 JIC Male Couplings	1
21A	ARC-031	Outlet Adaptor 1" 1/4 BSP x 1" 5/16 JIC Male Couplings	1
22	ARC-021	Inlet Adaptor 3/4" BSP x 1" BSP Male Couplings	1
22A	ARC-023	Outlet Adaptor 1" BSP x 1" 1/4 BSP Male Couplings	1
23	ARC-008D	1" Dowty Seal	1
24	ARC-048	1" 1/4 Dowty Seal	1
25	S180-011	Thrust Bush	1
26	S180-012	Lower Bush	1
27	ARC-001	Dowel Pin	4
28	ARC-098	Seloc Pins	2
29	ARC-002	1/4" BSP Plug	1
30	S180-150	Hammer Box	1
31	S180-101	Lower Buffer	1
32	S180-100	Top Buffer	1
33	S180-065	Tool Retainer Stopper Plate	1
34	ARC-007	Tool Retainer Stopper Plate Cap Screw	4
35	ARC-060	Top Bracket	1
36	ARC-016	Top Bracket Bolt Assembly	15
	ARC-122	Decal Set	1
	ARC-012	Gas Charging Kit	1
	S180-200	Operators/Parts Manual	1
	ARC-043	3/4" Four Wire Nominal Bore Hose with 1 1/16" JIC Fittings 2.6m	1
	ARC-044	1" Nominal Bore Two Wire Hose with 1 5/16" JIC Fittings 2.6m	1
	ARC-036	3/4" Four Wire Nominal Bore Hose with 3/4" BSP Fittings 2.6m	1
	ARC-037	1" Nominal Bore Two Wire Hose with 1" BSP Fittings 2.6m	1

Item No.	Part No.	TYPE 1	
A	S180-002	Chuck Housing	1
B	S180-005	Combination Bush	1
C	ARC-001	Dowel Pin	2

S180 Hammer

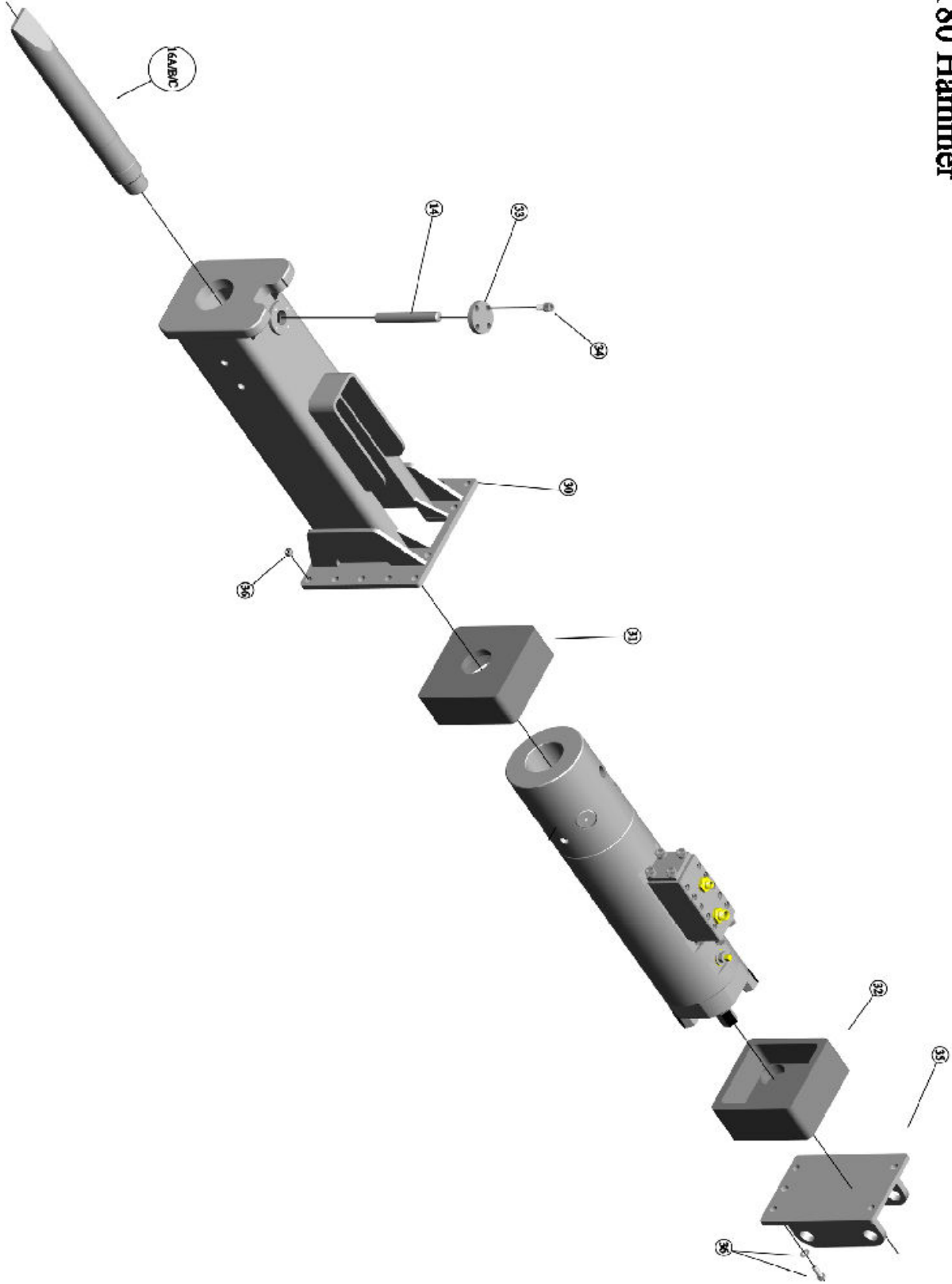

GAS VALVE ASSEMBLY

